

# AUTOMATIC FEEDER - MODEL 300-29X

## REPLACEMENT PARTS

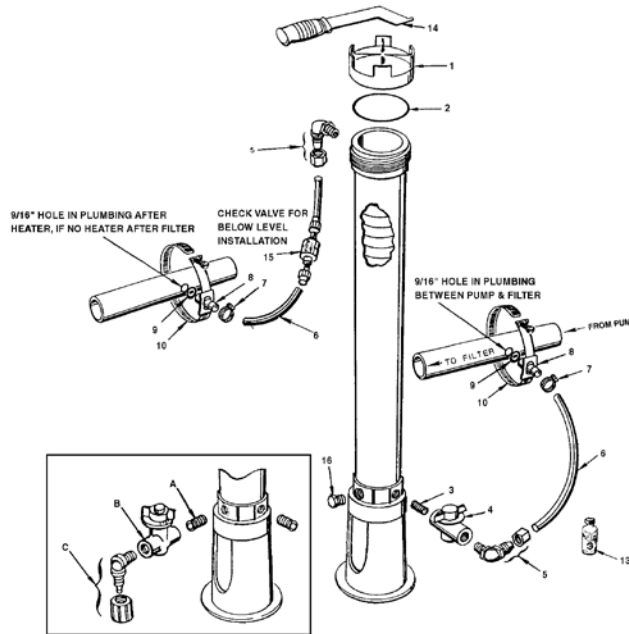

| Item                                       | Qty. | Part No.  | Description   |
|--|------|-----------|---|
| <b>Order No.: R171070</b>                  |      |           |   |
| <b>Model No.: 300-29X</b>                  |      |           |   |
| <b>Description: COMMERCIAL SIZE FEEDER</b> |      |           |   |
| 1  | 1    | R172008W  | 3 in. threaded cap, white                                   |
| 2  | 1    | R172009Z  | O-ring, cap   |
| 3  | 1    | R172256Z  | 1/2 in. x Short MPT nipple                                  |
| 4  | 1    | R172086Z  | 1/2 in. Control valve                                       |
| 5  | 2    | R172272Z  | 1/2 in. 90° NPT x tube fitting w/nut                        |
| 5  | Opt. | R172274Z  | Compression nut only (for R172272Z)                         |
| 6  | 1    | R172269   | 1/2 in. i.d. Feeder tube, 12 ft.                            |
| 7  | 2    | R175013   | S/S tubing clamp  |
| 8  | 2    | R172262Z  | Saddle tube fitting   |
| 9  | 2    | R172263Z  | Saddle gasket   |
| 10   | 2    | R172264Z  | Saddle clamp  |
| 10A  | Opt. | R172264XL | Saddle clamp for 3 in., 4 in. & 6 in. pipe                  |
| 11   | 1    | R172392   | 1/4 in. MPT PVC plug (old style)                            |
| 13   | 1    | R172036Z  | Silicone lubricant, 3/4 oz.                                 |
| 14   | Opt. | R172052   | Cap wrench  |
| 15   | Opt. | R172324NS | 1/2 in. Corrosion resistant check valve, tube x tube (ball) |
| 16   | 1    | R172134   | 1/2 in. MPT PVC plug  |

| Item                                  | Qty. | Part No. | Description                          |
|---------------------------------------|------|----------|--------------------------------------|
| <b>Order No.: R172275</b>             |      |          |                                      |
| <b>Parts bag for 300-29X Complete</b> |      |          |                                      |
| 3                                     | 1    | R172256Z | 1/2 in. x Short MPT nipple           |
| 4                                     | 1    | R172086Z | 1/2 in. Control valve                |
| 5                                     | 2    | R172272Z | 1/2 in. 90° NPT x tube fitting w/nut |
| 5                                     | Opt. | R172274Z | Compression nut only (for R172272Z)  |
| 7                                     | 2    | R175013  | S/S tubing clamp                     |
| 8                                     | 2    | R172262Z | Saddle tube fitting                  |
| 9                                     | 2    | R172263Z | Saddle gasket                        |
| 10                                    | 2    | R172264Z | Saddle clamp                         |
| 13                                    | 1    | R172036Z | Silicone lubricant                   |

| <b>Order No.: R172002</b> |  |          |                                      |
|---------------------------|--|----------|--------------------------------------|
| <b>Optional Drain Kit</b> |  |          |                                      |
| A                         |  | R172256Z | 1/2 in. Short MPT nipple             |
| B                         |  | R172086Z | 1/2 in. Control valve                |
| C                         |  | R172272Z | 1/2 in. 90° NPT x tube fitting w/nut |

CALIFORNIA PROPOSITION 65 WARNING  
 ⚠️ **WARNING:** Cancer and Reproductive Harm.  
 ⚠️ **AVERTISSEMENT:** Peut Causer le Cancer et des Dommages au Système Reproducteur.  
 ⚠️ **ADVERTENCIA:** Cáncer y Daño Reproductivo.  
[www.p65warnings.ca.gov](http://www.p65warnings.ca.gov) PK202174